

Dimension:  
Unit:mm

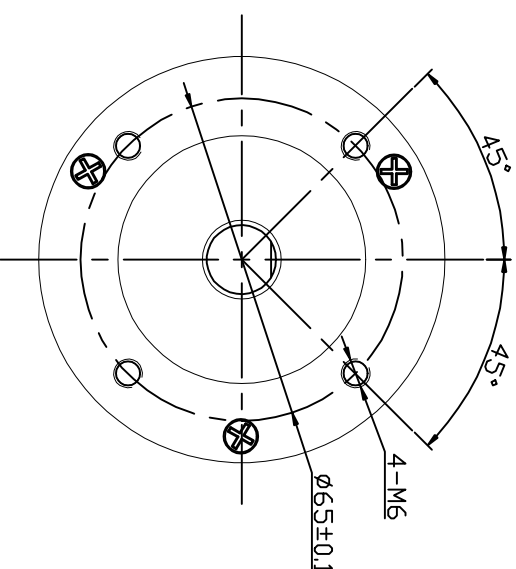
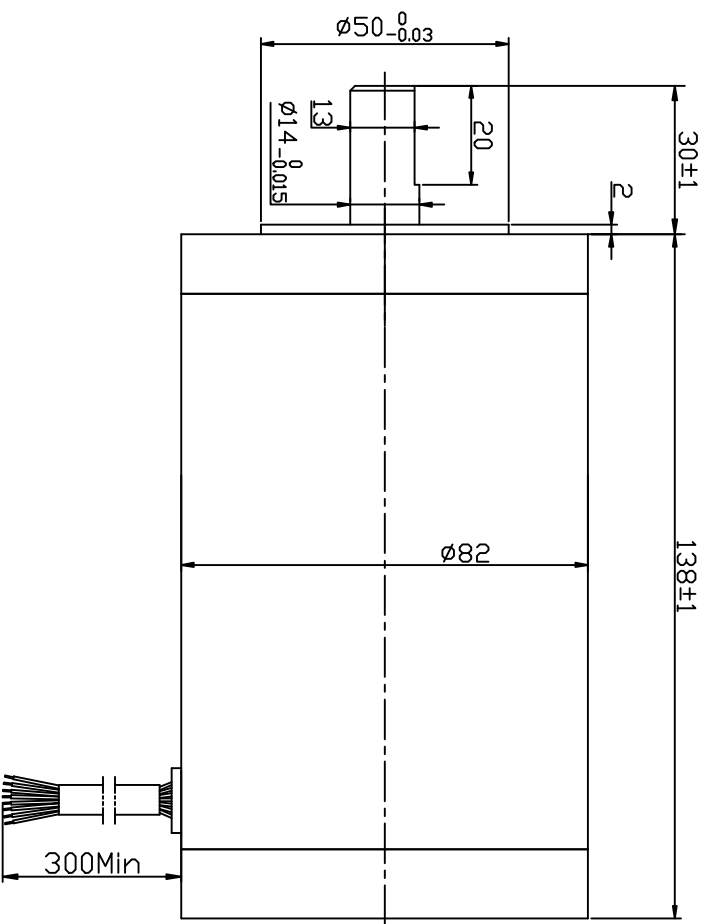

ROTATION: CCW SEE FROM LEAD END

MANUFACTURER MODEL	JK80BLS04
NUMBER OF POLES	4
PHASE TO PHASERESISTANCE	0.23 OHMS
NOMINAL VOLTAGE	48 VDC
ND LOAD SPEED	3700±10% RPM
ND LOAD CURRENT	1.1 Amps Max.
RATED TORQUE	1.4 N-m
RATED SPEED	3000±10% RPM
OUTPUT POWER	440 W
BACK EMF CONSTANT	13 V/KRPM
TORQUE CONSTANT	0.124 N-m/A
INSULATION CLASS	B

ELECTRICAL CONNECTION TABLE

+5V	RED	紅	UL1007 26 AWG
HALL U	YEL	黃	
HALL V	GRE	綠	UL1015 18 AWG
HALL W	BLU	藍	
GND	BLK	黑	
PHASE U	YEL	黃	
PHASE V	GRE	綠	
PHASE W	BLU	藍	

Connection diagram:

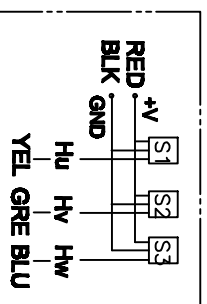

Hall sensor cable  
Note: hall sensor power supply  
voltage +5 to +20VDC

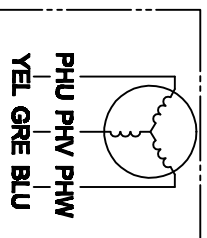

Wiring cable

REV. QTY:	No.	SIG.	DATE
DESIGN	WH	18.01.20	STD.
CHECK			
PROC.			

Title:		常州精控电机电器有限公司	
Specification		JK80BLS04	
CLS.MAK	WEIGHT	SCALE	
PAGE: 1/1		www.jkongmotor.com	